

CEILING CONCEALED DUCT



Features & Benefits

- E.S.P. control function can make air volume controlled easily with remote controller.
- The BLDC motor can control fan speed and air volume regardless of the external static pressure.
- No additional accessories are necessary to control air flow.

Key Applications

- Hotel / Conference center
- Retail / shopping center
- School
- Office
- Restaurant
- Church
- Historic building

Duct		High	Middle	Low
SMART	Wi-Fi	o	o	o
ENERGY EFFICIENCY	E.S.P. Control	o	o	o
	Drain Pump	o	o	o
	Timer(on/off)	o	o	o
COMFORT	Timer(weekly)	o	o	o
	Two thermistor control	o	o	o
	Group control	o	o	o

Wi-Fi Control

Control your air conditioners via using the smart internet devices as Android or iOS based smartphones. This advanced technology provides you the best convenience.

LG SmartThinQ



Search "LG SmartThinQ" on Google market or Appstore then download the app.

Access your air conditioner anytime and from anywhere

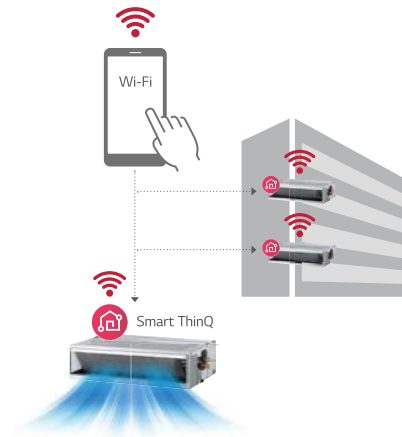

Easy Registration and Log-in

Follow the easy set-up steps that will activate SmartThinQ's impressive feature.

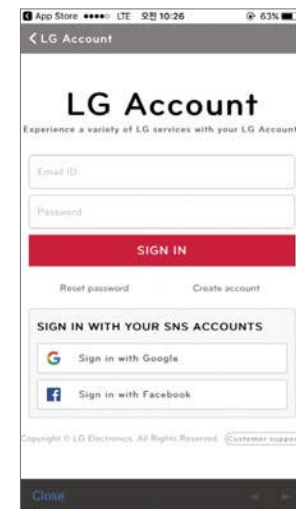

E.S.P.(External Static Pressure) Control

E.S.P. control function can make air volume controlled easily with remote controller. The BLDC motor can control fan speed and air volume regardless of the external static pressure. No additional accessories are necessary to control air flow.

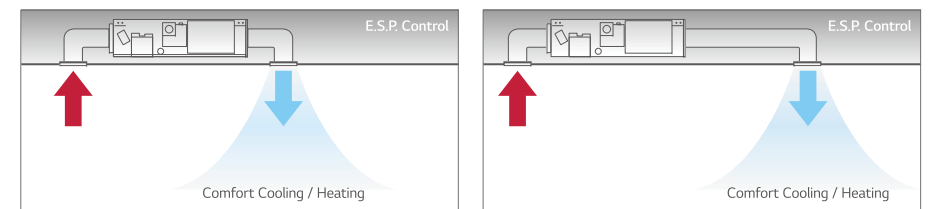

CEILING CONCEALED DUCT

Static Pressure 11 Step Control (Only for Ceiling Concealed Duct)

Depending on the installation environment, 4series ceiling concealed duct is controlled the static pressure to 11 step, for providing comfortable environment suitable for any environment.

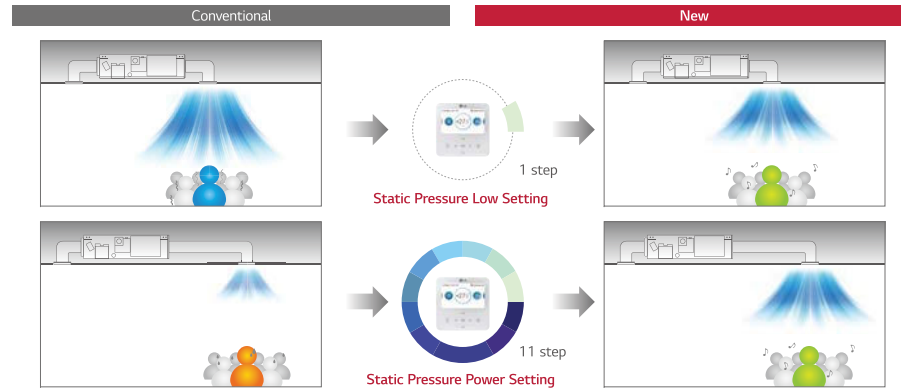

Energy Monitoring (Accumulated Electric Energy Check)

Accumulated electric energy of the indoor unit can be identified with wired remote control, as well as with the central controller. This function is an advantage for energy management.

Install Scene



Apply for multistory building



* Outdoor unit's accumulated electric energy / using rate of individual indoor unit + indoor unit's accumulated electric energy is displayed in wired remote controller, only when central controller, digital integrating electricity meter and PDI are installed and PDI, outdoor unit and indoor unit are connected with power wire. Only total accumulated electric energy is displayed in standard wired remote controller. In premium wired remote controller, that are displayed into week / month / year.

Operation for Multiple Rooms

Using a spiral duct (embedded or flexible type) and stream chamber, it is possible to operate cooling / heating for several rooms simultaneously.

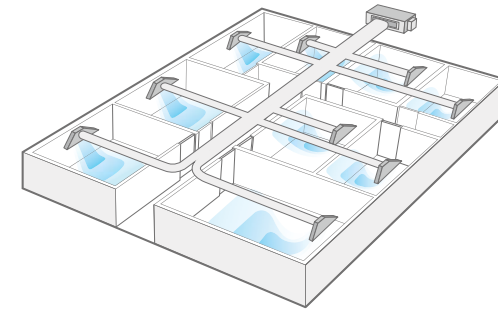

Filter Sign (Remaining Time)

The alarm is activated when the filter needs to be cleaned, and the time remaining for cleaning is displayed on the screen, which is convenient for users.

Remain time until indoor filter cleaning + alarm



Flexible Installation (Low Static Duct Only)

The new low static duct allows the air intake at the rear or bottom under installation condition.

Air intake at the rear or bottom

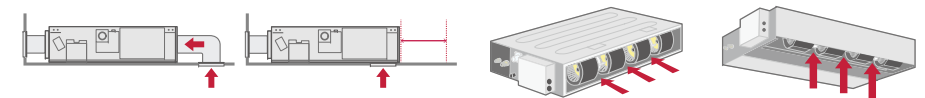

CEILING CONCEALED DUCT

Minimized Height

New mid-static ducts provide ideal solution for installation in limited space.

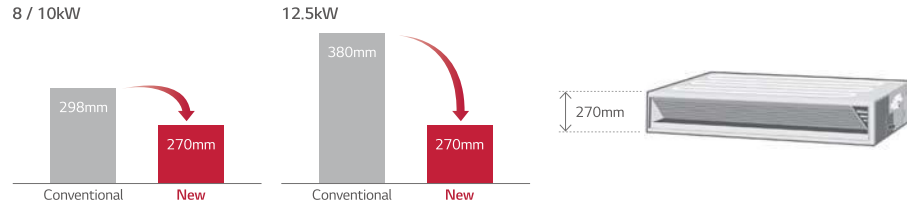

Two Thermistors Control

The indoor temperature can be checked using the thermistors in the remote controller as well as from the indoor unit. There may be a significant difference between ceiling and floor air temperature. Two thermistors can optimise indoor air temperature for a more comfortable environment.

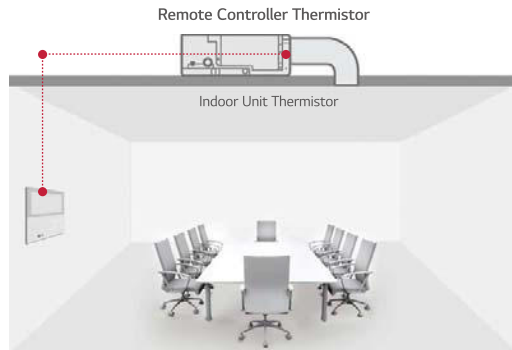

1 Point External Input (On / Off Control)

Indoor unit can control external devices without dry contact, so customer can save cost of installation.

Connection between an indoor unit and external devices directly

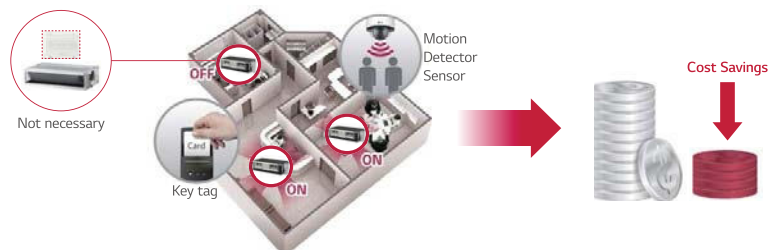

* In case of needing more functions beside on / off control, a dry contact is required to be installed.

MID / HIGH STATIC

ARNU07GM1A4 / ARNU09GM1A4 / ARNU12GM1A4
ARNU15GM1A4 / ARNU18GM1A4 / ARNU24GM1A4



Model	Unit	ARNU07GM1A4	ARNU09GM1A4	ARNU12GM1A4	ARNU15GM1A4	ARNU18GM1A4	ARNU24GM1A4	
Cooling Capacity	kW	2.2	2.8	3.6	4.5	5.6	7.1	
Heating Capacity	kW	2.5	3.2	4.0	5.0	6.3	8.0	
Power Input (H / M / L)	Nominal	W	39	40	46	67	85	
	Body	mm	900 x 270 x 700	900 x 270 x 700	900 x 270 x 700	900 x 270 x 700	900 x 270 x 700	
Dimensions (W x H x D)	Shipping	mm	1,100 x 338 x 773	1,100 x 338 x 773	1,100 x 338 x 773	1,100 x 338 x 773	1,100 x 338 x 773	
	Type		Sirocco Fan	Sirocco Fan	Sirocco Fan	Sirocco Fan	Sirocco Fan	
Fan	Motor Output x Number	W x No.	136 x 1	136 x 1	136 x 1	136 x 1	136 x 1	
	Air Flow Rate (H / M / L)	m³/min	9.0 / 7.5 / 6.0	9.5 / 7.5 / 6.0	11.0 / 9.0 / 7.0	16.0 / 12.0 / 9.0	17.0 / 14.5 / 12.0	19.0 / 16.0 / 14.0
	External static pressure (High mode)	mmAq (Pa)	6(59)	6(59)	6(59)	6(59)	6(59)	6(59)
	Air Flow Rate (H / M / L) (Standard mode)	m³/min	9.0 / 7.5 / 6.0	9.5 / 7.5 / 6.0	11.0 / 9.0 / 7.0	16.0 / 12.0 / 9.0	17.0 / 14.5 / 12.0	19.0 / 16.0 / 14.0
	External static pressure (Standard mode)	mmAq (Pa)	2.5(25)	2.5(25)	2.5(25)	2.5(25)	2.5(25)	2.5(25)
	Motor type		BLDC	BLDC	BLDC	BLDC	BLDC	BLDC
	Air Filter		Pre Filter	Pre Filter	Pre Filter	Pre Filter	Pre Filter	Pre Filter
Pipe Connections	Liquid Side	mm (inch)	Ø6.35(1/4)	Ø6.35(1/4)	Ø6.35(1/4)	Ø6.35(1/4)	Ø9.52(3/8)	
	Gas Side	mm (inch)	Ø12.7(1/2)	Ø12.7(1/2)	Ø12.7(1/2)	Ø12.7(1/2)	Ø15.88(5/8)	
	Drain Pipe (Internal Dia.)	mm (inch)	25(1)	25(1)	Ø25 (1)	Ø25 (1)	Ø25 (1)	
Weight	Body	kg	25.5	25.5	25.5	25.5	26.5	
	Sound Pressure Levels (H / M / L)	dB (A)	26 / 24 / 23	27 / 25 / 23	27 / 25 / 23	30 / 27 / 23	31 / 28 / 25	32 / 29 / 26
Sound Power Levels (H / M / L)	dB (A)	55 / 54 / 51	55 / 54 / 52	56 / 54 / 52	59 / 57 / 55	59 / 57 / 55	59 / 58 / 56	
Power Supply	Ø, V, Hz		1, 220-240, 50	1, 220-240, 50	1, 220-240, 50	1, 220-240, 50	1, 220-240, 50	
			1, 220, 60	1, 220, 60	1, 220, 60	1, 220, 60	1, 220, 60	
Communication Cable	mm² x No.	1.0-1.5 x 2C	1.0-1.5 x 2C	1.0-1.5 x 2C	1.0-1.5 x 2C	1.0-1.5 x 2C	1.0-1.5 x 2C	

1) Nominal : Performance tested under EN14511

2) Rated : Max power input allowed for fan motor

Note : 1. Capacities are based on the following conditions

- Cooling : Indoor temp. 27°C (80.6°F) DB / 19°C (66.2°F) WB, Outdoor temp. 35°C (95°F) DB / 24°C (75.2°F) WB, Interconnecting piping length 7.5m, Level difference of zero

- Heating : Indoor temp. 20°C (68°F) DB / 15°C (59°F) WB, Outdoor temp. 7°C (44.6°F) DB / 6°C (42.8°F) WB, Interconnecting piping length 7.5m, Level difference of zero

2. Due to our policy of innovation some specifications may be changed without notification

3. ID : "Internal Diameter"

4. The Sound Pressure test condition is based on 50 Pa for middle static duct.

Accessories

Chassis	ARNU07GM1A4	ARNU09GM1A4	ARNU12GM1A4	ARNU15GM1A4	ARNU18GM1A4	ARNU24GM1A4
Drain Pump				○		
Cassette Cover				-		
Refrigerant Leakage Detector			PRLDNV50			
EEV Kit			PRGK024A0(-5.6kW)			
Independent Power Module			PRIPO			
Robot Cleaner			-			
Pre Filter (washable / anti-fungus)			○			
Ion Generator			-			
CO ₂ Sensor			-			
Ventilation Kit			-			
IR Receiver			PWLRVN000			
Zone Controller			ABZCA			
Dry Contact (with additional accessory)			PDRYCB000 (1 point contact)			
			PDRYCB300 (8 points for thermostat compatible)			
			PDRYCB400 (2 points input)			
			PDRYCB500 (Modbus)			
External Input (1 point)			○			
Wi-Fi			PWFMD200			

※ ○ : Applied, - : Not applied

Option : Refer to model name in table

ARNU28GM2A4 / ARNU36GM2A4 / ARNU42GM2A4
ARNU48GM3A4 / ARNU54GM3A4



Model	Unit	ARNU28GM2A4	ARNU36GM2A4	ARNU42GM2A4	ARNU48GM3A4	ARNU54GM3A4	
Cooling Capacity	kW	8.2	10.6	12.3	14.1	15.8	
Heating Capacity	kW	9.2	11.9	13.8	15.9	18.0	
Power Input (H / M / L)	Nominal	W	123	184	231	172	260
	Body	mm	1,250 x 270 x 700	1,250 x 270 x 700	1,250 x 270 x 700	1,250 x 360 x 700	1,250 x 360 x 700
Dimensions (W x H x D)	Shipping	mm	1,450 x 338 x 773	1,450 x 338 x 773	1,450 x 338 x 773	1,450 x 428 x 773	1,450 x 428 x 773
	Type		Sirocco Fan	Sirocco Fan	Sirocco Fan	Sirocco Fan	Sirocco Fan
Fan	Motor Output x Number	W x No.	350 x 1	350 x 1	350 x 1	350 x 1	350 x 1
	Air Flow Rate (H / M / L)	m³/min	28.0 / 24.0 / 21.0	32.0 / 28.0 / 24.0	38.0 / 33.0 / 28.0	40.0 / 34.0 / 28.0	50.0 / 45.0 / 40.0
	External static pressure (High mode)	mmAq (Pa)	6(59)	6(59)	6(59)	6(59)	6(59)
	Air Flow Rate (H / M / L) (Standard mode)	m³/min	28.0 / 24.0 / 21.0	32.0 / 28.0 / 24.0	38.0 / 33.0 / 28.0	40.0 / 34.0 / 28.0	50.0 / 45.0 / 40.0
	External static pressure (Standard mode)	mmAq (Pa)	5(49)	5(49)	5(49)	5(49)	5(49)
	Motor type		BLDC	BLDC	BLDC	BLDC	BLDC
	Air Filter		Pre Filter	Pre Filter	Pre Filter	Pre Filter	Pre Filter
Pipe Connections	Liquid Side	mm (inch)	Ø9.52(3/8)	Ø9.52(3/8)	Ø9.52(3/8)	Ø9.52(3/8)	
	Gas Side	mm (inch)	Ø15.88(5/8)	Ø15.88(5/8)	Ø15.88(5/8)	Ø15.88(5/8)	
	Drain Pipe (Internal Dia.)	mm (inch)	Ø25 (1)	Ø25 (1)	Ø25 (1)	Ø25 (1)	
Weight	Body	kg	38.0	38.0	39.5	44.0	
	Sound Pressure Levels (H / M / L)	dB (A)	36 / 34 / 33	37 / 36 / 34	38 / 37 / 36	39 / 37 / 35	42 / 40 / 39
Sound Power Levels (H / M / L)	dB (A)	59 / 57 / 55	60 / 59 / 57	62 / 61 / 60	63 / 60 / 59	65 / 64 / 62	
Power Supply	Ø, V, Hz		1, 220-240, 50	1, 220-240, 50	1, 220-240, 50	1, 220-240, 50	
			1, 220, 60	1, 220, 60	1, 220, 60	1, 220, 60	
Communication Cable	mm² x No.	1.0-1.5 x 2C	1.0-1.5 x 2C	1.0-1.5 x 2C	1.0-1.5 x 2C	1.0-1.5 x 2C	

1) Nominal : Performance tested under EN14511

2) Rated : Max power input allowed for fan motor

Note : 1. Capacities are based on the following conditions

- Cooling : Indoor temp. 27°C (80.6°F) DB / 19°C (66.2°F) WB, Outdoor temp. 35°C (95°F) DB / 24°C (75.2°F) WB, Interconnecting piping length 7.5m, Level difference of zero

- Heating : Indoor temp. 20°C (68°F) DB / 15°C (59°F) WB, Outdoor temp. 7°C (44.6°F) DB / 6°C (42.8°F) WB, Interconnecting piping length 7.5m, Level difference of zero

2. Due to our policy of innovation some specifications may be changed without notification

3. ID : "Internal Diameter"

4. The Sound Pressure test condition is based on 50 Pa for middle static duct.

Accessories

Chassis	ARNU28GM2A4	ARNU36GM2A4	ARNU42GM2A4	ARNU48GM3A4	ARNU54GM3A4
Drain Pump				○	
Cassette Cover				-	
Refrigerant Leakage Detector			PRLDNV50		
EEV Kit			-		
Independent Power Module			PRIPO		
Robot Cleaner			-		
Pre Filter (washable / anti-fungus)			○		
Ion Generator			-		
CO ₂ Sensor			-		
Ventilation Kit			-		
IR Receiver			PWLRVN000		
Zone Controller			ABZCA		
Dry Contact (with additional accessory)			PDRYCB000 (1 point contact)		
			PDRYCB300 (8 points for thermostat compatible)		
			PDRYCB400 (2 points input)		
			PDRYCB500 (Modbus)		
External Input (1 point)			○		
Wi-Fi			PWFMD200		

※ ○ : Applied, - : Not applied

Option : Refer to model name in table

HIGH STATIC

ARNU76GB8A4 / ARNU96GB8A4



Model	Unit	ARNU76GB8A4	ARNU96GB8A4
Cooling Capacity	kW	22.4	28.0
Heating Capacity	kW	25.2	31.5
Power Input (H / M / L)	Nominal	W	765 / 500 / 500
			800 / 750 / 750
Dimensions (W x H x D)	Body	mm	1,562 x 460 x 688
	Shipping	mm	1,806 x 537 x 825
Fan	Type		Sirocco Fan
	Motor Output x Number	W x No.	375 x 2
	Air Flow Rate (H / M / L)	m ³ /min	60.0 / 50.0 / 50.0
	External static pressure (High mode)	mmAq (Pa)	22(216)
	Air Flow Rate (H / M / L) (Standard mode)	m ³ /min	64.0 / 50.0 / 50.0
	External static pressure (Standard mode)	mmAq (Pa)	15(147)
	Motor type		BLDC
Air Filter		Pre Filter	Pre Filter
Pipe Connections	Liquid Side	mm (inch)	Ø9.52(3/8)
	Gas Side	mm (inch)	Ø19.05(3/4)
	Drain Pipe (Internal Dia.)	mm (inch)	Ø25 (1)
Weight	Body	kg	87.0
			1, 220, 60
Power Supply	Ø, V, Hz	1, 220-240, 50	1, 220, 60
Communication Cable	mm ² x No.	1.0-1.5 x 2C	1.0-1.5 x 2C

1) Nominal : Performance tested under EN14511

2) Rated : Max power input allowed for fan motor

Note : 1. Capacities are based on the following conditions

- Cooling : Indoor temp. 27°C (80.6°F) DB / 19°C (66.2°F) WB, Outdoor temp. 35°C (95°F) DB / 24°C (75.2°F) WB, Interconnecting piping length 7.5m, Level difference of zero

- Heating : Indoor temp. 20°C (68°F) DB / 15°C (59°F) WB, Outdoor temp. 7°C (44.6°F) DB / 6°C (42.8°F) WB, Interconnecting piping length 7.5m, Level difference of zero

2. Due to our policy of innovation some specifications may be changed without notification

3. LD : 'Internal Diameter'

4. The Sound Pressure test condition is based on 50 Pa for middle static duct.

Accessories

Chassis	ARNU76GB8A4	ARNU96GB8A4
Drain Pump	○	○
Cassette Cover	-	-
Refrigerant Leakage Detector	PRLDNV50	○
EEV Kit	○	○
Independent Power Module	PRIP0	○
Robot Cleaner	-	-
Pre Filter (washable / anti-fungus)	○	○
Ion Generator	-	-
CO ₂ Sensor	-	-
Ventilation Kit	-	-
IR Receiver	PWLRVN000	○
Zone Controller	ABZCA	○
Dry Contact (with additional accessory)	PDRYCB000 (1 point contact)	○
	PDRYCB300 (8 points for thermostat compatible)	○
	PDRYCB400 (2 points input)	○
	PDRYCB500 (Modbus)	○
External Input (1 point)	○	○
Wi-Fi	PWFMD200	○

※ ○ : Applied, - : Not applied

Option : Refer to model name in table

LOW STATIC

ARNU05GL1G4 / ARNU07GL1G4 / ARNU09GL1G4



Model	Unit	ARNU05GL1G4	ARNU07GL1G4	ARNU09GL1G4
Cooling Capacity	kW	1.7	2.2	2.8
Heating Capacity	kW	1.9	2.5	3.2
Power Input (H / M / L)	Nominal	W	29 / 26 / 24	31 / 28 / 24
			39 / 29 / 24	
Dimensions (W x H x D)	Body	mm	700 x 190 x 700	700 x 190 x 700
	Shipping	mm	862 x 255 x 781	862 x 255 x 781
Fan	Type		Sirocco Fan	Sirocco Fan
	Motor Output x Number	W x No.	19 x 1	19 x 1
	Air Flow Rate (H / M / L)	m ³ /min	6.7 / 6.2 / 5.5	7.5 / 6.5 / 5.5
	External static pressure (High mode)	mmAq (Pa)	2.54 (25)	2.54 (25)
	Air Flow Rate (H / M / L) (Standard mode)	m ³ /min	6.7 / 6.2 / 5.5	7.5 / 6.5 / 5.5
	External static pressure (Standard mode)	mmAq (Pa)	0 (0)	0 (0)
	Motor type		BLDC	BLDC
Air Filter		Pre Filter	Pre Filter	Pre Filter
Pipe Connections	Liquid Side	mm (inch)	Ø6.35(1/4)	Ø6.35(1/4)
	Gas Side	mm (inch)	Ø12.7(1/2)	Ø12.7(1/2)
	Drain Pipe (Internal Dia.)	mm (inch)	Ø25 (1)	Ø25 (1)
Weight	Body	kg	17.5	17.5
			1, 220 - 240, 50	1, 220 - 240, 50
Sound Pressure Levels (H / M / L)	dB(A)	25 / 24 / 22	26 / 24 / 22	28 / 25 / 22
Sound Power Levels (H / M / L)	dB(A)	48 / 46 / 45	50 / 47 / 45	53 / 49 / 45
Power Supply	Ø, V, Hz	1, 220 - 240, 50	1, 220 - 240, 50	1, 220 - 240, 50
Communication Cable	mm ² x No.	1.0-1.5 x 2C	1.0-1.5 x 2C	1.0-1.5 x 2C

1) Nominal : Performance tested under EN14511

2) Rated : Max power input allowed for fan motor

Note : 1. Capacities are based on the following conditions

- Cooling : Indoor temp. 27°C (80.6°F) DB / 19°C (66.2°F) WB, Outdoor temp. 35°C (95°F) DB / 24°C (75.2°F) WB, Interconnecting piping length 7.5m, Level difference of zero

- Heating : Indoor temp. 20°C (68°F) DB / 15°C (59°F) WB, Outdoor temp. 7°C (44.6°F) DB / 6°C (42.8°F) WB, Interconnecting piping length 7.5m, Level difference of zero

3. LD : 'Internal Diameter'

4. L2, L3 : The Sound Pressure test condition is based on 20 Pa (Static Pressure) as standard.

Accessories

Chassis	ARNU05GL1G4	ARNU07GL1G4	ARNU09GL1G4
Drain Pump	○	○	○
Cassette Cover	-	-	-
Refrigerant Leakage Detector	○	PRLDNV50	○
EEV Kit	○	PRGK024A0	○
Independent Power Module	○	PRIP0	○
Robot Cleaner	-	-	-
Pre Filter (washable / anti-fungus)	○	○	○
Ion Generator	-	-	-
CO ₂ Sensor	-	-	-
Ventilation Kit	-	-	-
IR Receiver	○	PWLRVN000	○
Zone Controller	○	ABZCA	○
Dry Contact (with additional accessory)	PDRYCB000 (1 point contact)	○	○
	PDRYCB300 (8 points for thermostat compatible)	○	○
	PDRYCB400 (2 points input)	○	○
	PDRYCB500 (Modbus)	○	○
External Input (1 point)	○	○	○
Wi-Fi	PWFMD200	○	○

※ ○ : Applied, - : Not applied

Option : Refer to model name in table

LOW STATIC

ARNU12GL2G4 / ARNU15GL2G4 / ARNU18GL2G4



Model	Unit	ARNU12GL2G4	ARNU15GL2G4	ARNU18GL2G4
Cooling Capacity	kW	19 x 1, 5 x 1	19 x 1, 5 x 1	19 x 1, 5 x 1
Heating Capacity	kW	10.0 / 8.5 / 7.0	12.5 / 10.0 / 8.5	15.0 / 12.5 / 10.0
Power Input (H / M / L)	Nominal	W	2.54 (25)	2.54 (25)
Dimensions (W x H x D)	Body	mm	10.0 / 8.5 / 7.0	12.5 / 10.0 / 8.5
	Shipping	mm	0 (0)	0 (0)
Fan	Type		BLDC	BLDC
	Motor Output x Number	W x No.	Pre Filter	Pre Filter
	Air Flow Rate (H / M / L)	m³/min	Ø6.35(1/4)	Ø6.35(1/4)
	External static pressure (High mode)	mmAq (Pa)	Ø12.7(1/2)	Ø12.7(1/2)
	Air Flow Rate (H / M / L) (Standard mode)	m³/min	Ø25 (1)	Ø25 (1)
	External static pressure (Standard mode)	mmAq (Pa)	23.0	23.0
	Motor type		30 / 27 / 25	33 / 30 / 28
Air Filter		50 / 47 / 46	54 / 51 / 47	
Pipe Connections	Liquid Side	mm (inch)	1, 220 - 240, 50	1, 220 - 240, 50
	Gas Side	mm (inch)	1, 220, 60	1, 220, 60
	Drain Pipe (Internal Dia.)	mm (inch)	1.0-1.5 x 2C	1.0-1.5 x 2C
Weight	kg	17.5	17.5	
Sound Pressure Levels (H / M / L)	dB(A)	25 / 24 / 22	26 / 24 / 22	
Sound Power Levels (H / M / L)	dB(A)	48 / 46 / 45	50 / 47 / 45	
Power Supply	Ø, V, Hz	1, 220 - 240, 50	1, 220 - 240, 50	
		1, 220, 60	1, 220, 60	
Communication Cable	mm² x No.	1.0-1.5 x 2C	1.0-1.5 x 2C	

1) Nominal : Performance tested under EN14511

2) Rated : Max power input allowed for fan motor

Note : 1. Capacities are based on the following conditions

- Cooling : Indoor temp. 27°C (80.6°F) DB / 19°C (66.2°F) WB, Outdoor temp. 35°C (95°F) DB / 24°C (75.2°F) WB, Interconnecting piping length 7.5m, Level difference of zero

- Heating : Indoor temp. 20°C (68°F) DB / 15°C (59°F) WB, Outdoor temp. 7°C (44.6°F) DB / 6°C (42.8°F) WB, Interconnecting piping length 7.5m, Level difference of zero

2. Due to our policy of innovation some specifications may be changed without notification

3. L1 : Internal Diameter

4. L2, L3 : The Sound Pressure test condition is based on 20 Pa (Static Pressure) as standard.

Accessories

Chassis	ARNU12GL2G4	ARNU15GL2G4	ARNU18GL2G4
Drain Pump		○	
Cassette Cover		-	
Refrigerant Leakage Detector		PRLDNV50	
EEV Kit		-	
Independent Power Module		PRIPO	
Robot Cleaner		-	
Pre Filter (washable / anti-fungus)		○	
Ion Generator		-	
CO ₂ Sensor		-	
Ventilation Kit		-	
IR Receiver		PWLRVN000	
Zone Controller		ABZCA	
Dry Contact (with additional accessory)		PDRYCB000 (1 point contact)	
		PDRYCB300 (8 points for thermostat compatible)	
		PDRYCB400 (2 points input)	
		PDRYCB500 (Modbus)	
External Input (1 point)		○	
Wi-Fi		PWFMD200	

※ ○ : Applied, - : Not applied

Option : Refer to model name in table

ARNU21GL3G4 / ARNU24GL3G4



Model	Unit	ARNU21GL3G4	ARNU24GL3G4
Cooling Capacity	kW	6.2	7.1
Heating Capacity	kW	7.0	8.0
Power Input (H / M / L)	Nominal	W	72 / 53 / 48
Dimensions (W x H x D)	Body	mm	1,100 x 190 x 700
	Shipping	mm	1,262 x 255 x 781
Fan	Type		Sirocco Fan
	Motor Output x Number	W x No.	19 x 2
	Air Flow Rate (H / M / L)	m³/min	17.5 / 14.0 / 12.0
	External static pressure (High mode)	mmAq (Pa)	2.54 (25)
	Air Flow Rate (H / M / L) (Standard mode)	m³/min	17.5 / 14.0 / 12.0
	External static pressure (Standard mode)	mmAq (Pa)	0 (0)
	Motor type		BLDC
Air Filter		Pre Filter	
Pipe Connections	Liquid Side	mm (inch)	Ø9.52(3/8)
	Gas Side	mm (inch)	Ø15.88(5/8)
	Drain Pipe (Internal Dia.)	mm (inch)	Ø25 (1)
Weight	kg	27.0	
Sound Pressure Levels (H / M / L)	dB(A)	35 / 29 / 28	
Sound Power Levels (H / M / L)	dB(A)	59 / 55 / 54	
Power Supply	Ø, V, Hz	1, 220 - 240, 50	
		1, 220, 60	
Communication Cable	mm² x No.	1.0-1.5 x 2C	

1) Nominal : Performance tested under EN14511

2) Rated : Max power input allowed for fan motor

Note : 1. Capacities are based on the following conditions

- Cooling : Indoor temp. 27°C (80.6°F) DB / 19°C (66.2°F) WB, Outdoor temp. 35°C (95°F) DB / 24°C (75.2°F) WB, Interconnecting piping length 7.5m, Level difference of zero

- Heating : Indoor temp. 20°C (68°F) DB / 15°C (59°F) WB, Outdoor temp. 7°C (44.6°F) DB / 6°C (42.8°F) WB, Interconnecting piping length 7.5m, Level difference of zero

2. Due to our policy of innovation some specifications may be changed without notification

3. L1 : Internal Diameter

4. L2, L3 : The Sound Pressure test condition is based on 20 Pa (Static Pressure) as standard.

Accessories

Chassis	ARNU21GL3G4	ARNU24GL3G4
Drain Pump		○
Cassette Cover		-
Refrigerant Leakage Detector		PRLDNV50
EEV Kit		PRGK024A0
Independent Power Module		PRIPO
Robot Cleaner		-
Pre Filter (washable / anti-fungus)		○
Ion Generator		-
CO ₂ Sensor		-
Ventilation Kit		-
IR Receiver		PWLRVN000
Zone Controller		ABZCA
Dry Contact (with additional accessory)		PDRYCB000 (1 point contact)
		PDRYCB300 (8 points for thermostat compatible)
		PDRYCB400 (2 points input)
		PDRYCB500 (Modbus)
External Input (1 point)		○
Wi-Fi		PWFMD200

※ ○ : Applied, - : Not applied

Option : Refer to model name in table

HIGH SENSIBLE

ARNU07GM2A4 / ARNU09GM2A4 / ARNU12GM2A4 / ARNU15GM2A4
ARNU28GM2A4 / ARNU36GM2A4 / ARNU42GM2A4



Model	Unit	ARNU07GM2A4	ARNU09GM2A4	ARNU12GM2A4	ARNU15GM2A4	ARNU28GM2A4	ARNU36GM2A4	ARNU42GM2A4	
Cooling Capacity	kW	2.2	2.8	3.6	4.5	8.2	10.6	12.3	
Heating Capacity	kW	2.5	3.2	4.0	5.0	9.2	11.9	13.8	
Power Input	Nominal W	30	30	30	30	123	184	231	
Dimensions (W x H x D)	Body mm	1,250 x 270 x 700	1,250 x 270 x 700	1,250 x 270 x 700	1,250 x 270 x 700	1,250 x 270 x 700	1,250 x 270 x 700	1,250 x 270 x 700	
Fan	Type	Sirocco Fan	Sirocco Fan	Sirocco Fan	Sirocco Fan	Sirocco Fan	Sirocco Fan	Sirocco Fan	
	Motor Output x Number	W	350 x 1	350 x 1	350 x 1	350 x 1	350 x 1	350 x 1	
	Air Flow Rate (H / M / L) (High Mode-Factory Set)	CMM	12.8 / 7.7 / 7.7	12.8 / 7.7 / 7.7	13.6 / 8.7 / 8.7	13.6 / 8.7 / 8.7	28.0 / 24.0 / 21.0	32.0 / 28.0 / 24.0	38.0 / 33.0 / 28.0
	External Static Pressure	cfm	452 / 272 / 272	452 / 272 / 272	480 / 307 / 307	480 / 307 / 307	989 / 848 / 742	1,130 / 989 / 848	1,342 / 1,165 / 989
		mmAq(Pa)	6(59)	6(59)	6(59)	6(59)	6(59)	6(59)	6(59)
	Air Flow Rate (H / M / L) (Standard Mode) External Static Pressure	CM	12.8 / 7.7 / 7.7	12.8 / 7.7 / 7.7	13.6 / 8.7 / 8.7	13.6 / 8.7 / 8.7	28.0 / 24.0 / 21.0	32.0 / 28.0 / 24.0	38.0 / 33.0 / 28.0
		cfm	452 / 272 / 272	452 / 272 / 272	480 / 307 / 307	480 / 307 / 307	989 / 848 / 742	1,130 / 989 / 848	1,342 / 1,165 / 989
	mmAq(Pa)	5(49)	5(49)	5(49)	5(49)	5(49)	5(49)	5(49)	
Motor Type		BLDC	BLDC	BLDC	BLDC	BLDC	BLDC	BLDC	
Air Filter		-	-	-	-	-	-	-	
Safety Device		Fuse	Fuse	Fuse	Fuse	Fuse	Fuse	Fuse	
Pipe Connections	Liquid Side	mm(inch)	Ø9.52(3/8)	Ø9.52(3/8)	Ø9.52(3/8)	Ø9.52(3/8)	Ø9.52(3/8)	Ø9.52(3/8)	
	Gas Side	mm(inch)	Ø15.88(5/8)	Ø15.88(5/8)	Ø15.88(5/8)	Ø15.88(5/8)	Ø15.88(5/8)	Ø15.88(5/8)	
	Drain Pipe(Internal Dia.)	mm(inch)	25(1)	25(1)	25(1)	25(1)	25(1)	25(1)	
Net Weight	Body kg(lbs)	38.0(84)	38.0(84)	38.0(84)	38.0(84)	38.0(84)	38.0(84)	39.5(87)	
Sound Pressure Levels (H / M / L)	dB(A)	38 / 36 / 36	38 / 36 / 36	38 / 36 / 36	38 / 36 / 36	36 / 34 / 33	37 / 36 / 34	38 / 37 / 36	
Sound Power Levels (H / M / L)	dB(A)	54 / 53 / 53	54 / 53 / 53	53 / 52 / 52	53 / 52 / 52	59 / 57 / 55	60 / 59 / 57	62 / 61 / 60	
Power Supply	Ø, V, Hz	1, 220-240, 50	1, 220-240, 50	1, 220-240, 50	1, 220-240, 50	1, 220-240, 50	1, 220-240, 50	1, 220-240, 50	
Transmission Cable		1, 220, 60	1, 220, 60	1, 220, 60	1, 220, 60	1, 220, 60	1, 220, 60	1, 220, 60	
		1.0-1.5 x 2C	1.0-1.5 x 2C	1.0-1.5 x 2C	1.0-1.5 x 2C	1.0-1.5 x 2C	1.0-1.5 x 2C	1.0-1.5 x 2C	

1) Nominal : Performance tested under EN14511

2) Rated : Max power input allowed for fan motor

Note : 1. Capacities are based on the following conditions

- Cooling : Indoor temp. 27°C (80.6°F) DB / 19°C (66.2°F) WB, Outdoor temp. 35°C (95°F) DB / 24°C (75.2°F) WB, Interconnecting piping length 7.5m, Level difference of zero

- Heating : Indoor temp. 20°C (68°F) DB / 15°C (59°F) WB, Outdoor temp. 7°C (44.6°F) DB / 6°C (42.8°F) WB, Interconnecting piping length 7.5m, Level difference of zero

2. Due to our policy of innovation some specifications may be changed without notification

3. ID : Internal Diameter

* These models will be developed until February (After the completion of the development, the air flow and noise information may be partially changed.)

Accessories

Chassis	ARNU07GM2A4	ARNU09GM2A4	ARNU12GM2A4	ARNU15GM2A4	ARNU28GM2A4	ARNU36GM2A4	ARNU42GM2A4
Drain Pump				○			
Cassette Cover				-			
Refrigerant Leakage Detector				PRLDNV50			
EEV Kit				-			
Independent Power Module				PRIPO			
Robot Cleaner				-			
Pre Filter (washable / anti-fungus)				○			
Ion Generator				-			
CO ₂ Sensor				-			
Ventilation Kit				-			
IR Receiver				PWLRVN000			
Zone Controller				ABZCA			
Dry Contact (with additional accessory)				PDRYCB000 (1 point contact) PDRYCB300 (8 points for thermostat compatible) PDRYCB400 (2 points input) PDRYCB500 (Modbus)			
External Input (1 point)				○			
Wi-Fi				PWFMD200			

※ ○ : Applied, - : Not applied

Option : Refer to model name in table

ARNU18GM3A4 / ARNU24GM3A4 / ARNU28GM3A4



Model	Unit	ARNU18GM3A4	ARNU24GM3A4	ARNU28GM3A4	
Cooling Capacity	kW	5.6	7.1	8.2	
Heating Capacity	kW	6.3	8.0	9.2	
Power Input	Nominal W	50	75	75	
Dimensions (W x H x D)	Body mm	Galvanized Steel Plate	Galvanized Steel Plate	Galvanized Steel Plate	
Fan	Type	1,250 x 360 x 700	1,250 x 360 x 700	1,250 x 360 x 700	
	Motor Output x Number	W	Sirocco Fan	Sirocco Fan	
	Air Flow Rate (H / M / L) (High Mode-Factory Set)	CMM	350 x 1	350 x 1	350 x 1
	External Static Pressure	cfm	32.7 / 26.7 / 23.0	35.5 / 30.6 / 26.2	35.5 / 30.6 / 26.2
		mmAq(Pa)	1,155 / 943 / 812	1,254 / 1,081 / 925	1,254 / 1,081 / 925
	Air Flow Rate (H / M / L) (Standard Mode) External Static Pressure	CM	6(59)	6(59)	6(59)
		cfm	32.7 / 26.7 / 23.0	35.5 / 30.6 / 26.2	35.5 / 30.6 / 26.2
	mmAq(Pa)	1,155 / 943 / 812	1,254 / 1,081 / 925	1,254 / 1,081 / 925	
Motor Type		5(49)	5(49)	5(49)	
Air Filter		BLDC	BLDC	BLDC	
Safety Device		-	-	-	
Pipe Connections	Liquid Side	mm(inch)	Ø9.52(3/8)	Ø9.52(3/8)	
	Gas Side	mm(inch)	Ø15.88(5/8)	Ø15.88(5/8)	
	Drain Pipe(Internal Dia.)	mm(inch)	25(1)	25(1)	
Net Weight	Body kg(lbs)	44(97)	44(97)	44(97)	
Sound Pressure Levels (H / M / L)	dB(A)	39 / 37 / 36	40 / 38 / 37	40 / 38 / 37	
Sound Power Levels (H / M / L)	dB(A)	53 / 52 / 51	54 / 53 / 52	54 / 53 / 52	
Power Supply	Ø, V, Hz	1, 220-240, 50	1, 220-240, 50	1, 220-240, 50	
Transmission Cable		1, 220, 60	1, 220, 60	1, 220, 60	
		1.0-1.5 x 2C	1.0-1.5 x 2C	1.0-1.5 x 2C	

1) Nominal : Performance tested under EN14511

2) Rated : Max power input allowed for fan motor

Note : 1. Capacities are based on the following conditions

- Cooling : Indoor temp. 27°C (80.6°F) DB / 19°C (66.2°F) WB, Outdoor temp. 35°C (95°F) DB / 24°C (75.2°F) WB, Interconnecting piping length 7.5m, Level difference of zero

- Heating : Indoor temp. 20°C (68°F) DB / 15°C (59°F) WB, Outdoor temp. 7°C (44.6°F) DB / 6°C (42.8°F) WB, Interconnecting piping length 7.5m, Level difference of zero

2. Due to our policy of innovation some specifications may be changed without notification

3. ID : Internal Diameter

* These models will be developed until February (After the completion of the development, the air flow and noise information may be partially changed.)

Accessories

Chassis	ARNU18GM3A4	ARNU24GM3A4	ARNU28GM3A4
Drain Pump			○
Cassette Cover			-
Refrigerant Leakage Detector			PRLDNV50
EEV Kit			-
Independent Power Module			PRIPO
Robot Cleaner			-
Pre Filter (washable / anti-fungus)			○
Ion Generator			-
CO ₂ Sensor			-
Ventilation Kit			-
IR Receiver			PWLRVN000
Zone Controller			ABZCA
Dry Contact (with additional accessory)			PDRYCB000 (1 point contact) PDRYCB300 (8 points for thermostat compatible) PDRYCB400 (2 points input) PDRYCB500 (Modbus)
External Input (1 point)			○
Wi-Fi			PWFMD200

※ ○ : Applied, - : Not applied

Option : Refer to model name in table